



Thermotouch 5250 manual thermostat is a simple on/off temperature control for your underfloor heating.

Features a simple on/off switch and easy temperature adjustment dial. It works with external floor sensor and is suitable for use with off peak electricity tariffs and C-Bus systems.

Technical Data

Supply voltage	240V 50/60Hz
Maximum load	16A (3600W)
Temperature range	5 - 40°C
Warranty	3 year
IP rating	IP20
Width	86mm
Height	86mm
Depth	43mm

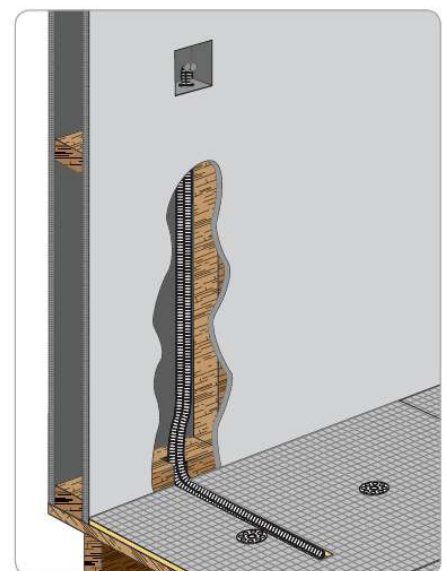

Floor temperature sensor should be installed in a conduit, within a clear area of the floor, and away from any other temperature influences.